

# ACCESORIOS CON ROSCA THREADED FITTINGS

## CODO 90° CON ESPIGA Y TUERCA PN25

90° THREADED ELBOW WITH UNION PN25



| ARTÍCULO | MEDIDAS mm  |
|----------|-------------|
| CODE     | SIZES mm    |
| CCD 2020 | 20 x 1/2"   |
| CCD 2025 | 20 x 3/4"   |
| CCD 2520 | 25 x 1/2"   |
| CCD 2525 | 25 x 3/4"   |
| CCD 2532 | 25 x 1"     |
| CCD 3232 | 32 x 1"     |
| CCD 3240 | 32 x 1 1/4" |

## ESPECIFICACIONES TÉCNICAS

TECHNICAL SPECIFICATIONS

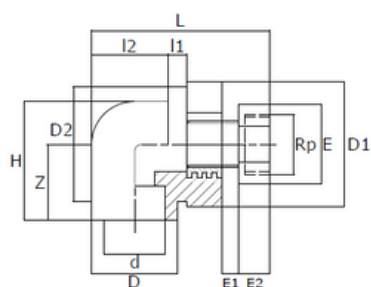

| ARTÍCULO | d  | Rp     | D  | D1 | D2 | I1 | I2 | L  | E  | E1 | E2 | H  | Z  | PESO (g) |
|----------|----|--------|----|----|----|----|----|----|----|----|----|----|----|----------|
| CCD 2020 | 20 | 1/2"   | 30 | 40 | 36 | 8  | 27 | 69 | 28 | 7  | 13 | 43 | 27 | 124      |
| CCD 2025 | 20 | 3/4"   | 30 | 40 | 36 | 8  | 27 | 65 | 33 | 4  | 13 | 43 | 27 | 128      |
| CCD 2532 | 25 | 1"     | 36 | 47 | 43 | 8  | 32 | 69 | 41 | 7  | 16 | 50 | 31 | 192      |
| CCD 3240 | 32 | 1 1/4" | 44 | 54 | 50 | 10 | 42 | 88 | 49 | 10 | 18 | 60 | 38 | 318      |

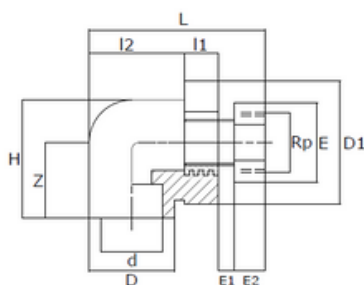

| ARTÍCULO | d  | Rp   | D  | D1 | I1 | I2 | L  | E  | E1 | E2 | H  | Z  | PESO (g) |
|----------|----|------|----|----|----|----|----|----|----|----|----|----|----------|
| CCD 2520 | 25 | 1/2" | 36 | 40 | 14 | 38 | 72 | 28 | 7  | 13 | 50 | 33 | 130      |
| CCD 2525 | 25 | 3/4" | 36 | 40 | 14 | 38 | 66 | 33 | 4  | 13 | 50 | 33 | 134      |
| CCD 3232 | 32 | 1"   | 44 | 48 | 15 | 54 | 84 | 41 | 7  | 16 | 60 | 38 | 212      |

Todos los accesorios TORO 25 son compatibles con todas las series de tubos TORO 25.  
All TORO 25 pipe fittings are compatible with all TORO 25 pipe series.

NSF 61 approved

STANDARDS:

- ISO 15874
- ISO 15494
- DIN 8077-78